

THOMAS CROY

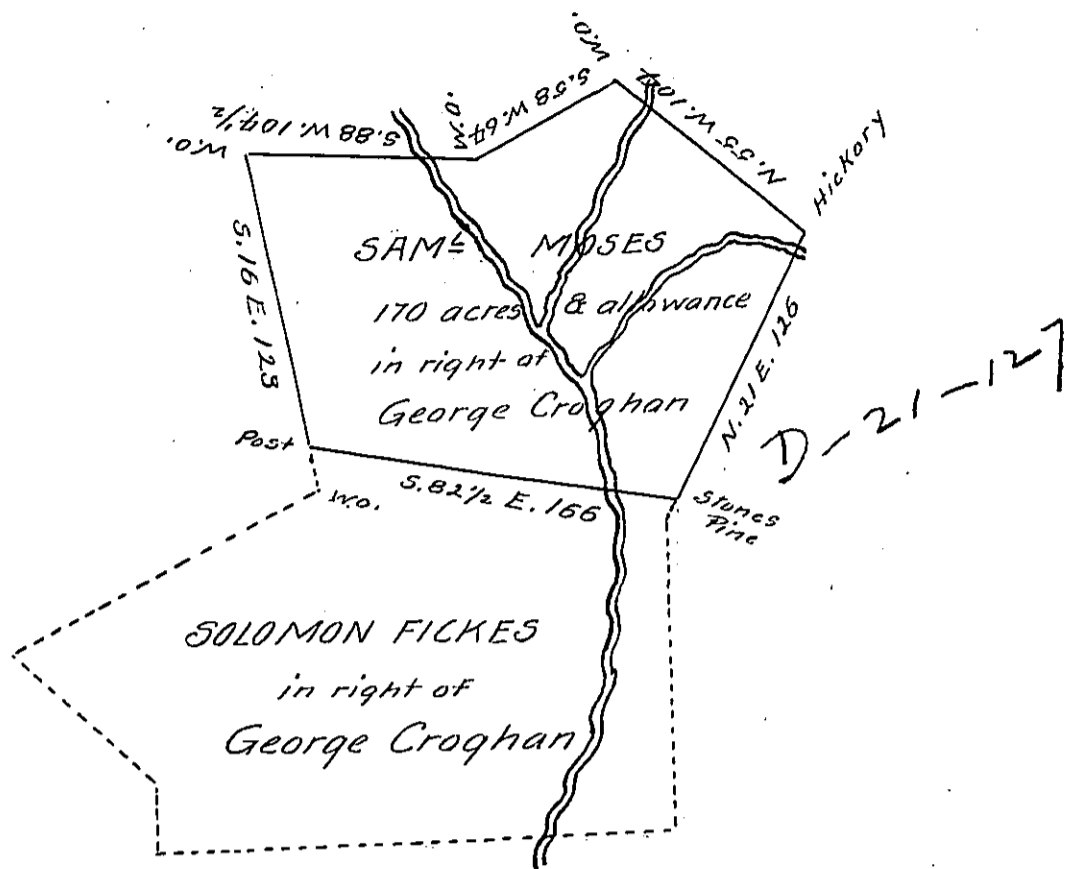

Situate on Scrub grass creek in Union Township Bedford County Containing 170 acres and allowance &c. being part of a larger Survey of 370 1/2 <sup>ac</sup> Originally surveyed for George Croghan Esq. in pursuance of a warrant dated the 3<sup>rd</sup> day of June 1763.

Surveyed for Samuel Moses the 9<sup>th</sup> day of May 1834

Returned for Patenting

To Jacob Spangler Esq. S.G.

Robert Stuart D.S

IN TESTIMONY that the above is a copy of the original remaining on file in the Department of Internal Affairs of Pennsylvania, made conformably to an Act of Assembly approved the 16th day of February, 1833, I have hereunto set my Hand and caused the Seal of said Department to be affixed at Harrisburg, this thirteenth day of May 1904

*James R. Brown*  
Secretary of Internal Affairs.